

Flexible Wireless Fire System Chosen for Bankside Refurbishment

The EMS 5000 FirePoint wireless fire system has been chosen as the fire detection solution for the Bankside substation refurbishment project. The refurbishment project is part of the new development on the south side of the Tate Modern, which when complete will provide 60% more gallery space and promises to be just as iconic as its power station neighbour. The Tate Modern extension is scheduled to be complete in time for the London Olympic Games in 2012.

The system will be designed and installed by EMS approved partner FDSA Fire Protection Limited working closely with Areva, the project manager and Arup, the design consultant. The wireless 5000 FirePoint system was chosen for its flexibility to cover all phases of the project. Not only does 5000 FirePoint provide a long-term solution for the project's fire detection needs, but it also allows a level of flexibility during the development that cannot be achieved with a traditional wired system. As the fire sensors and devices do not require wiring they can be temporarily re-sited as the development progresses. Similarly, once complete the protection can be moved and re-configured if the building layout changes or easily supplemented during further expansion - all without the need to add or change costly wiring.

The initial system consists of 4 radio-networked control panels, 150 wireless devices and 5 message pagers. The pagers allow staff to instantly receive text messages warning them of a fire or fault condition, wherever they are located on the premises. It is hoped that the subsequent works on the project, which will be taking place over the next three years, will see additional wireless equipment installed. EMS provide and manufacture a wide range of radio-based solutions includes analogue

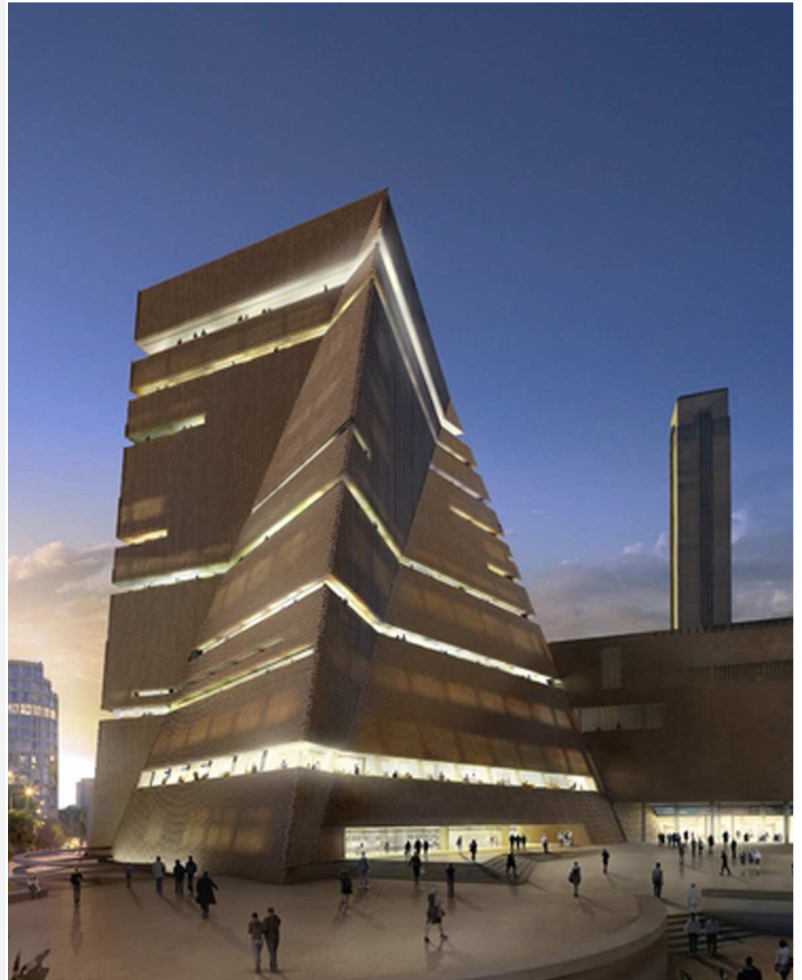

The Tate Modern extension is scheduled to be complete in time for the London Olympic Games in

fire, voice evacuation, intruder security and personal protection, all of which can be installed without the need for cable.

For Press & Editors

For more information on this article or other EMS publicity materials please contact pr@emsgroup.co.uk